

To be marked with 5mm steel types. The "arrow" can be made with a chisel.

NOTE: The SELF-LOCK threads which are marked with SL\* must be made in accordance to the SIMRAD procedure 842-202125.

SELF-LOCK taps can be supplied by SIMRAD.

- SURFACE TREATMENT:
1. SAND BLASTED TO SA 2.5
  2. ONE COATING OF RED FERRIC OXIDE PRIMER

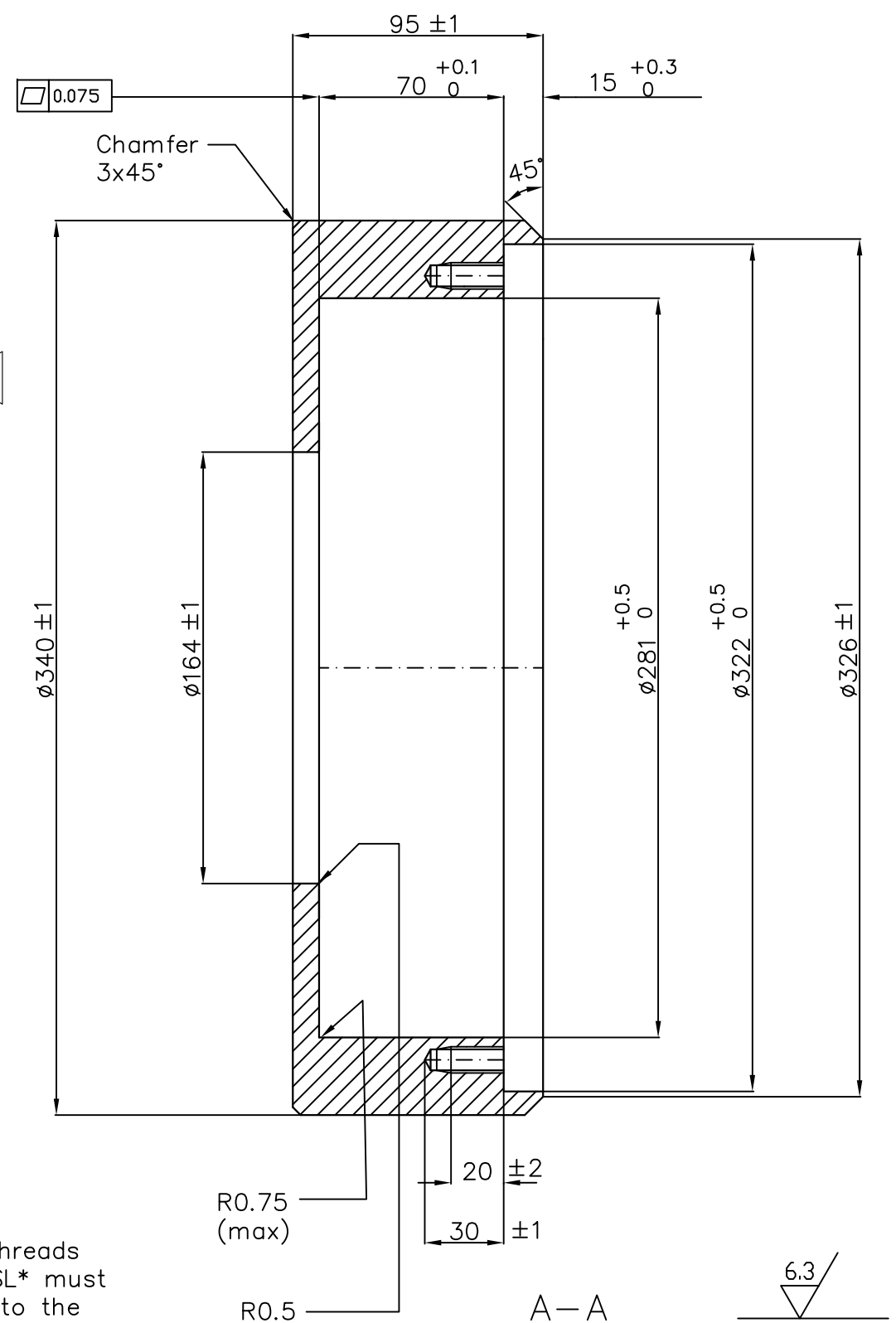

MATR.: STEEL TUBE, ST.52-3N (DIN 17121), ø343/ø163

REV./SIGN.	B	BOW							
DATE	2015.12.17								
PROJ. METHOD			UNLESS OTHERWISE STATED, TOLERANCE: DIM.: ISO 2768-mK THREAD: 6g/6H				PARTS LIST: 499-204715	<b>SIMRAD</b>	
SCALE	1:2.5		MOUNTING RING				SHEET 1 OF 1	SH.SIZE: A4	REV.:
DRAWN	2000.11.17	TW	TRANSDUCER				871-204716		B
CHECKED	2000.12.05	BØJ							
APPROVED	2000.12.06	KTP	ES70-7C				FILE NO.: -		